

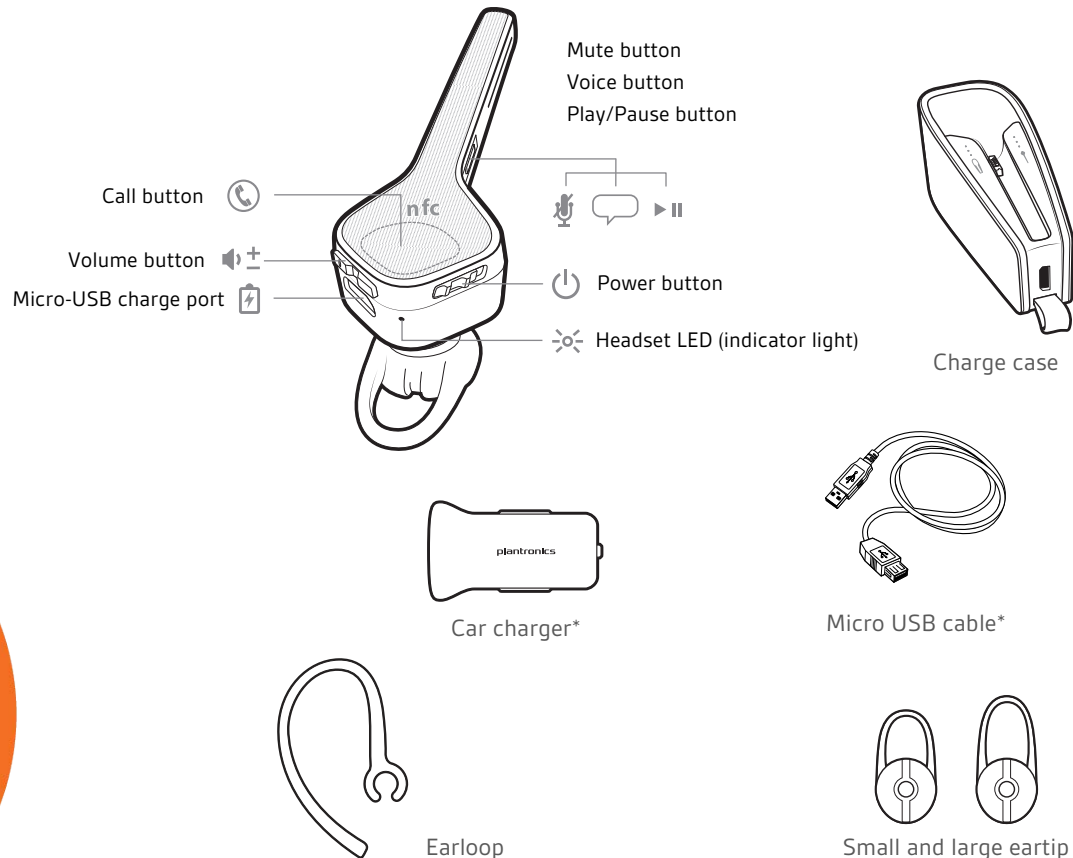

Voyager Edge Series The Basics



For immediate
technical or installation
support, call us at

800.641.6416



NOTE *Charger style may vary by product.

Registering Your Product and Plantronics Software

Visit plantronics.com/productregistration to register your product online so we can provide you with the best service and technical support.

We also recommend that you install the Plantronics software located at plantronics.com/software. With it installed you can:

- Customize your headset and USB adapter settings to your personal preferences
- Automatically manage your PC multimedia so you never miss a call
- Quickly access links to product support and software/firmware upgrade information

Pair

NOTE If your phone supports Near Field Communication (NFC), go to **NFC pairing**.

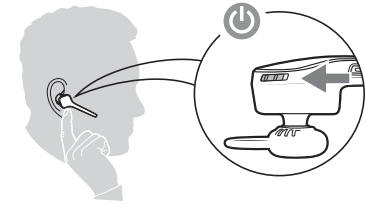

Bluetooth pairing

- 1 Wearing your headset, power it on. You hear “welcome” in all the supported languages and then “pairing” in the default language. The headset LED flashes red and blue.
- 2 Activate Bluetooth® on your phone and set it to search for new devices.
 - **iPhone Settings > Bluetooth > On***
 - **Android™ Settings > Bluetooth: On > Scan for devices***

NOTE *Menus may vary by device.

- 3 Select **“PLT_Edge.”** If necessary, enter four zeros (0000) for the passcode or accept the connection. Once successfully paired, you hear “pairing successful.”

NFC pairing

- 1 Ensure NFC is on and your phone’s display is unlocked.
- 2 Tap and hold the headset to the phone’s NFC tag location until NFC pairing completes. If necessary, accept the connection.

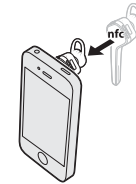

TIP Keep an eye on your Smartphone’s screen for prompts to start and accept the pairing process.



NOTE The headset’s NFC tag is located on the top of the headset. Phone NFC tag locations vary.

Pair Another Phone

After pairing your headset to your phone, you may want to pair another phone.

- 1 Power on your headset.
- 2 Choose:
 - Tap the Voice button  and say “Pair mode”
 - Press and hold the Call button  until you hear “pairing”
- 3 Activate Bluetooth on your phone and set it to search for new devices.
- 4 Select **“PLT_Edge.”**
If necessary, enter four zeros (0000) for the passcode or accept the connection.

Once successfully paired, you hear “pairing successful” and the headset indicator lights stop flashing.

The Basics



Make/Take/End Calls

Answer a call

Choose:

- Put on the headset to answer call, or
- Say “answer” after call is announced, or
- Tap the Call button 

Answer a second call

First, tap the Call button  to end current call, then tap the Call button  again to answer new call.

End a call

Tap the Call button  to end current call.

Reject a call

Choose:

- Say “ignore” after call is announced, or
- Press Call button  for 2 seconds

Call back last call

Double-tap the Call button  to call back the last active call regardless of whether it was an inbound or an outbound call.

NOTE *If no calls have been made or received in the current connected session this feature will not function. Double-tapping the Call button  will result in a single low tone for each button press; however will not connect you to the last active call from the previous session.*

Voice dial (phone feature)

If your smartphone has a voice-enabled assistant, press the call button  for 2 seconds and wait for phone prompt.

Caller Announcement (mobile phone only)

When wearing your headset, you will hear the name of a contact calling you so you can decide whether to answer or ignore the call without having to check the phone screen.

An incoming caller name is announced:

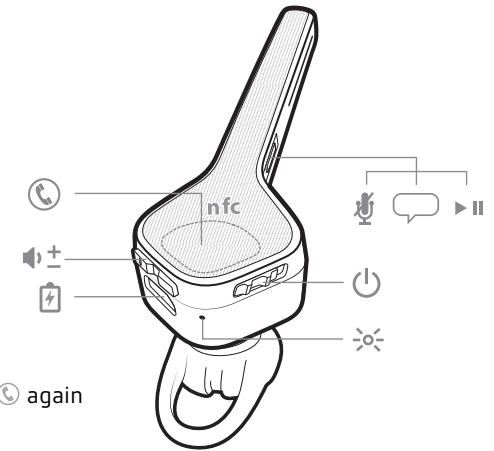

if your phone supports Phone Book Access Profile (PBAP)

if you granted access to your contacts during pairing process (for many mobile phones, this is preset out-of-the box and may not be necessary)

if the caller is stored in the phone's contacts list



An incoming caller name is not announced: if the caller is unknown, unlisted, or blocked

Mute

During a conversation, press the Mute button . You hear "mute on" or "mute off." An alert repeats every 15 minutes when mute is on.

NOTE *If the headset smart sensors are enabled (default), mute is deactivated when the headset is taken off and everyone can hear each other.*

Adjust the volume

Toggle the Volume button  up (+) or down (-) during a call or while streaming audio. While not on a call or streaming audio you can toggle the Volume button  to adjust the volume level for Caller Announce and other voice prompts.

Use Smart Sensors

Smart sensors in this headset recognize if the headset is being worn and can automatically perform time-saving functions.

Putting on your headset will:

- Answer an incoming call
- Transfer an active call from your phone
- Resume streaming audio

Taking off your headset will:



- Transfer an active call to your phone
- Pause streaming audio
- Lock the Call button to avoid accidental calls

Reset sensors

You may need to reset the sensors if they are not working as expected.

To reset your sensors, connect the headset directly to your computer's USB port, and place it, with the eartip up, on a flat non-metallic surface for more than 10 seconds.

Disable sensors

To disable the sensors, hold both the Voice  and Call  buttons for more than 6 seconds until the LED flashes purple then red. Repeat to reactivate; the LED flashes purple then blue.

NOTE *Sensors cannot be disabled while streaming audio.*

Play or pause streaming
audio

A 2-second press of the Play/Pause button  will either pause or resume playback of streaming audio.

NOTE *You must pause your streaming audio before you:*

- *use your headset's voice commands*
- *initiate an outbound call with your headset (call back or voice dial)*

NOTE *If you power off the headset or go out of phone range while streaming audio, your headset will not play/pause the stream upon reconnecting until you manually resume streaming with your phone.*