



Electronic Hook Switch Guide

Electronics Hook Switch Guide

Contents



1

ALCATEL • LUCENT



4

SIEMENS (OPTIPOINT)



2

CISCO



5

SIEMENS (OPENSTAGE)



3

POLYCOM



6

AVAYA

Alcatel • Lucent Deskphones

IP Touch 8 Series

4068
4028
4038

9 Series TDM

4039
4029



Please check plantronics.com for more phone options.

Savi Office

ORDER INFORMATION



Savi™ Office

Designed for seamless communication
Next generation of wireless headsets to maximize collaboration through multiple devices. Enterprise grade headset system providing excellent sound quality.
WO100
(Convertible headset system)



REMOTE CALL ANSWERING

Requires following EHS solution to automatically answer a call by pressing a button on the headset.
APA-20 (sold separately)



SET UP INFORMATION

For a complete set up list please refer to the user guide.

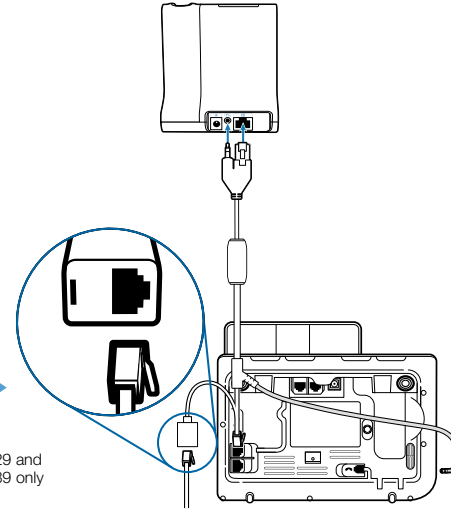

4029 and 4039 only

Set desk phone speaking volume to 2

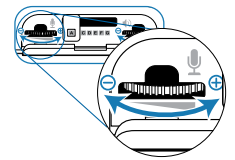

Configuration switch

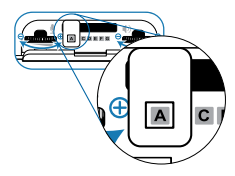

Set desk phone listening volume to 3

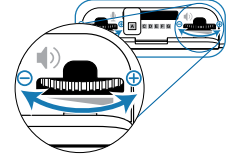

CS55/CS70N/Plantronics Voyager 510S/SupraPlus Wireless

ORDER INFORMATION

Plantronics Voyager® 510S System

Office and mobile phone usage
Use one headset for calls both in and out of the office with a noise cancelling microphone. Share seamlessly between office phone and Bluetooth® mobile phone or smart phone.
Voyager 510S



CS70N™ Wireless

Stylish and discreet
Combining the excellent sound quality and range of DECT™ with the design edge of a mobile headset.
CS70N



CS55™ Wireless

Flexible, cost effective and convenient
Cost-effective wireless headset with great range and sound quality and a choice of wearing styles.
CS55



SupraPlus® Wireless

All-day wearing comfort
For intensive phone users—the ultimate comfort and sound quality—with the option of binaural style for noisy environments.
CS351N Monaural
CS361N Binaural



REMOTE CALL ANSWERING

Requires following EHS solution to automatically answer a call by pressing a button on the headset.
APA-2 (sold separately)



SET UP INFORMATION

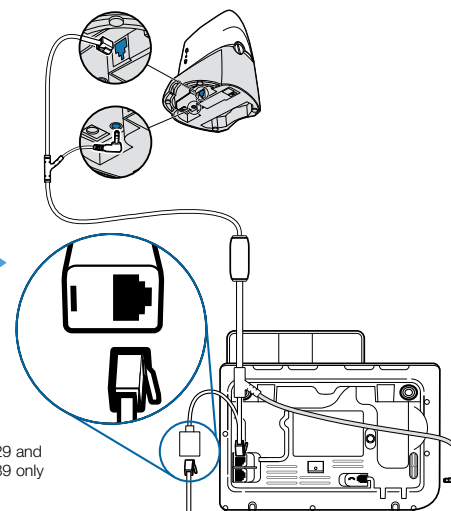

4029 and 4039 only

Set rotary switch to 1

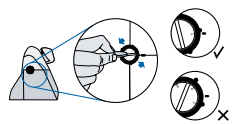

Set rear slide switch to 2

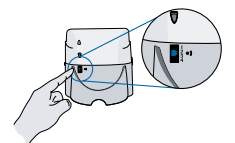

Set bottom slide switch to B

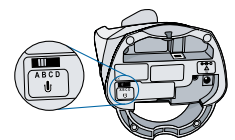

Cisco Deskphones

794X Series

7942G
7945G



796X Series

7962G
7965G



797X Series

7975G



Please check plantronics.com for more phone options.

Savi Office

ORDER INFORMATION



Savi™ Office

Designed for seamless communication

Next generation of wireless headsets to maximize collaboration through multiple devices. Enterprise grade headset system providing excellent sound quality.

WO100
(Convertible headset system)

REMOTE CALL ANSWERING

Requires following EHS solution to automatically answer a call by pressing a button on the headset.

APC-40 (sold separately)



SET UP INFORMATION

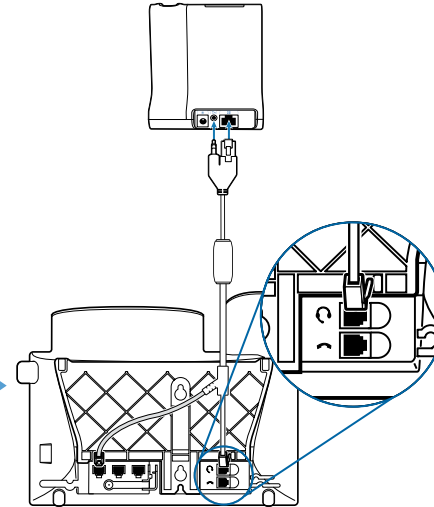

Set desk phone speaking volume to 2

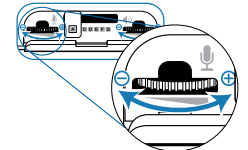

Configuration switch

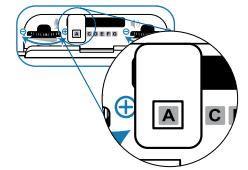

Set desk phone listening volume to 3

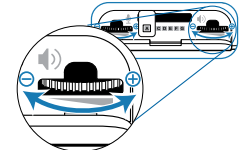

CS55/CS70N/Plantronics Voyager 510S/SupraPlus Wireless

ORDER INFORMATION



Bluetooth



Plantronics Voyager® 510S System

Office and mobile phone usage
Use one headset for calls both in and out of the office with a noise cancelling microphone. Share seamlessly between office phone and Bluetooth® mobile phone or smart phone.

Voyager 510S



CS70N™ Wireless

Stylish and discreet
Combining the excellent sound quality and range of DECT™ with the design edge of a mobile headset.

CS70N



CS55™ Wireless

Flexible, cost effective and convenient
Cost-effective wireless headset with great range and sound quality and a choice of wearing styles.

CS55



SupraPlus® Wireless

All-day wearing comfort
For intensive phone users—the ultimate comfort and sound quality—with the option of binaural style for noisy environments.

CS351N Monaural
CS361N Binaural

REMOTE CALL ANSWERING

Requires following EHS solution to automatically answer a call by pressing a button on the headset.

APC-4 (sold separately)



SET UP INFORMATION

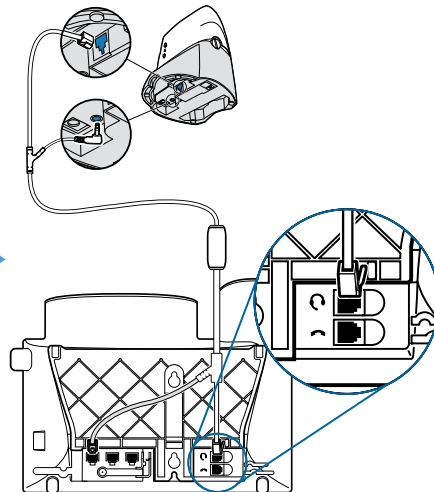

Set rotary switch to 1

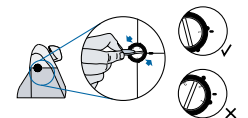

Set rear slide switch to 2

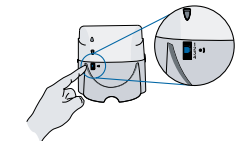

Set bottom slide switch to B

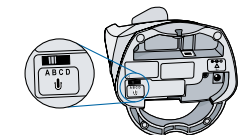

Polycom Deskphones

SoundPoint®

IP 320¹ IP 430¹ IP 560¹
 IP 321¹ IP 450³ IP 650¹
 IP 330¹ IP 550¹ IP 670²
 IP 331¹



SoundPoint IP 320 and IP 330 require 2.5mm to RJ-9 converter cable to connect to the headset port (sold separately).

- 1 Requires SIP application 3.1 or higher and BootROM 4.1.0 or later.
- 2 Requires SIP application 3.0.2 or higher and BootROM 4.1.0 or later.
- 3 Requires SIP application 3.1.0 Rev C or higher and BootROM 4.1.0 or later.

Please check plantronics.com for more phone options.

Savi Office

ORDER INFORMATION



Savi™ Office

Designed for seamless communication
 Next generation of wireless headsets to maximize collaboration through multiple devices. Enterprise grade headset system providing excellent sound quality.
WO100
 (Convertible headset system)

REMOTE CALL ANSWERING

Requires following EHS solution to automatically answer a call by pressing a button on the headset.
 APP-50 (sold separately)



SET UP INFORMATION

For a complete set up list please refer to the user guide.

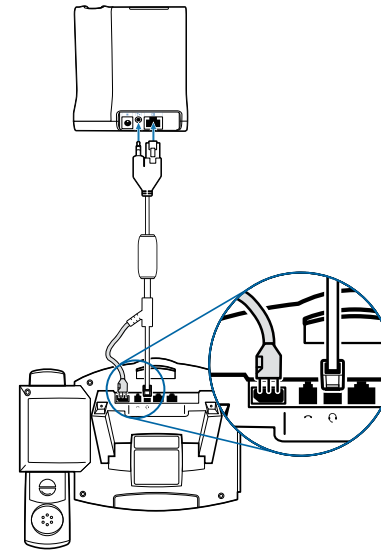

Set desk phone speaking volume to 2

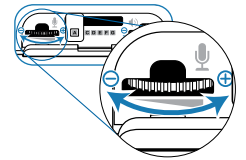

Configuration switch

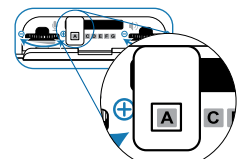

Set desk phone listening volume to 3

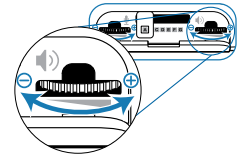

CS55/CS70N/Plantronics Voyager 510S/SupraPlus Wireless

ORDER INFORMATION



Plantronics Voyager® 510S System

Office and mobile phone usage
 Use one headset for calls both in and out of the office with a noise cancelling microphone. Share seamlessly between office phone and Bluetooth® mobile phone or smart phone.
 Voyager 510S



CS70N™ Wireless

Stylish and discreet
 Combining the excellent sound quality and range of DECT™ with the design edge of a mobile headset.
 CS70N



CS55™ Wireless

Flexible, cost effective and convenient
 Cost-effective wireless headset with great range and sound quality and a choice of wearing styles.
 CS55



SupraPlus® Wireless

All-day wearing comfort
 For intensive phone users—the ultimate comfort and sound quality—with the option of binaural style for noisy environments.
 CS351N Monaural
 CS361N Binaural



REMOTE CALL ANSWERING

Requires following EHS solution to automatically answer a call by pressing a button on the headset.
 APP-5 (sold separately)



SET UP INFORMATION

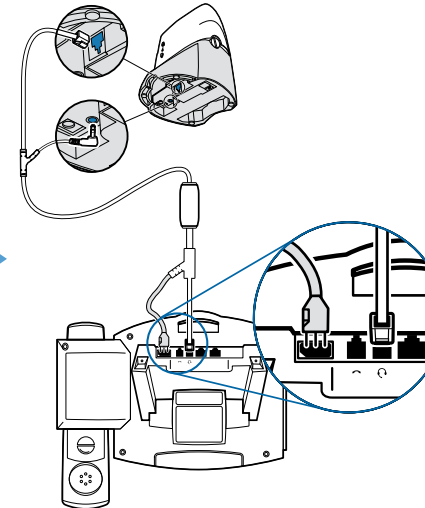

Set rotary switch to 1

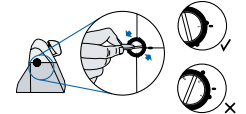

Set rear slide switch to 2

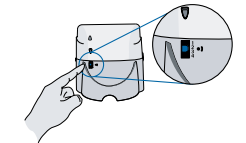

Set bottom slide switch to A

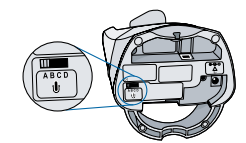

Siemens Deskphones

optiPoint®

- 410 with Acoustic Adapter
- 420 with Acoustic Adapter
- 500 with Acoustic Adapter
- 600 with Acoustic Adapter

System Requirements:

- HiPath 500 => Rel. 5.0
- HiPath 1220 => Rel. 2.1 build 032
- HiPath 2000 => Rel. 1.0
- HiPath 3000 => Rel. 4.0 SMR-07
- HiPath 4000 => Rel. 1.0

EHS support is not provided on Siemens Realitis Systems.

Please check plantronics.com for more phone options.



Savi Office

ORDER INFORMATION



Savi™ Office

Designed for seamless communication
Next generation of wireless headsets to maximize collaboration through multiple devices. Enterprise grade headset system providing excellent sound quality.
WO100
(Convertible headset system)

REMOTE CALL ANSWERING

Requires following EHS solution to automatically answer a call by pressing a button on the headset.
APS-10 +Acoustic Adapter
(supplied by Siemens, sold separately)



SET UP INFORMATION

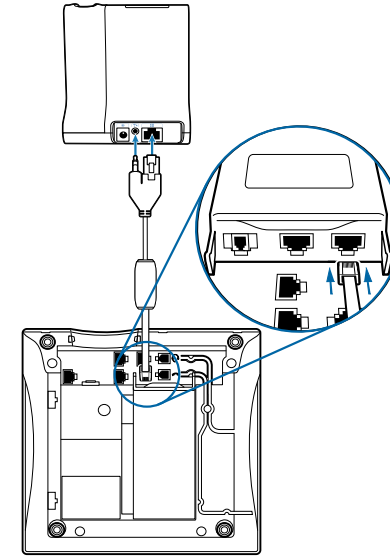

Set desk phone speaking volume to 2

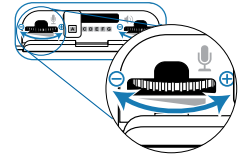

Configuration switch

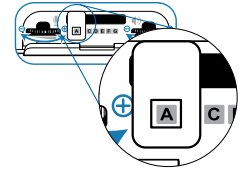

Set desk phone listening volume to 3

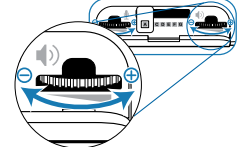

CS55/CS70N/Plantronics Voyager 510S/SupraPlus Wireless

ORDER INFORMATION

Plantronics Voyager® 510S System

Office and mobile phone usage
Use one headset for calls both in and out of the office with a noise cancelling microphone. Share seamlessly between office phone and Bluetooth® mobile phone or smart phone.
Bluetooth
Voyager 510S



CS70N™ Wireless

Stylish and discreet
Combining the excellent sound quality and range of DECT™ with the design edge of a mobile headset.
CS70N



CS55™ Wireless

Flexible, cost effective and convenient
Cost-effective wireless headset with great range and sound quality and a choice of wearing styles.
CS55



SupraPlus® Wireless

All-day wearing comfort
For intensive phone users—the ultimate comfort and sound quality—with the option of binaural style for noisy environments.
CS351N Monaural
CS361N Binaural



REMOTE CALL ANSWERING

Requires following EHS solution to automatically answer a call by pressing a button on the headset.
APS-1 +Acoustic Adapter
(supplied by Siemens, sold separately)



SET UP INFORMATION

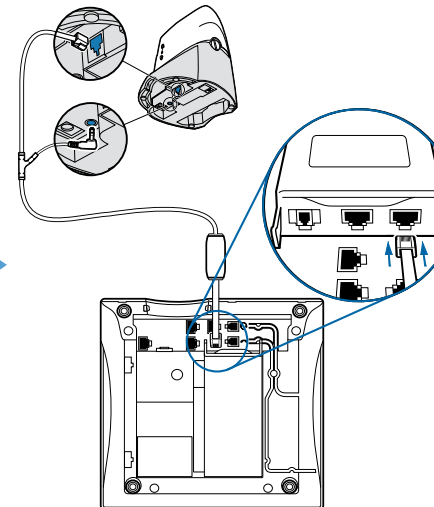

Set rotary switch to 1

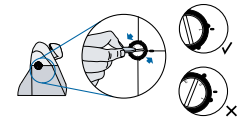

Set rear slide switch to 3

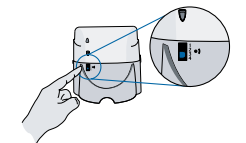

Set bottom slide switch to B

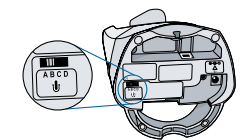

Siemens Deskphones

Openstage®

40
60
80



Please check plantronics.com for more phone options.

Savi Office

ORDER INFORMATION



Savi™ Office

Designed for seamless communication
Next generation of wireless headsets to maximize collaboration through multiple devices. Enterprise grade headset system providing excellent sound quality.
WO100
(Convertible headset system)

REMOTE CALL ANSWERING

Requires following EHS solution to automatically answer a call by pressing a button on the headset.
APS-10 (sold separately)



SET UP INFORMATION

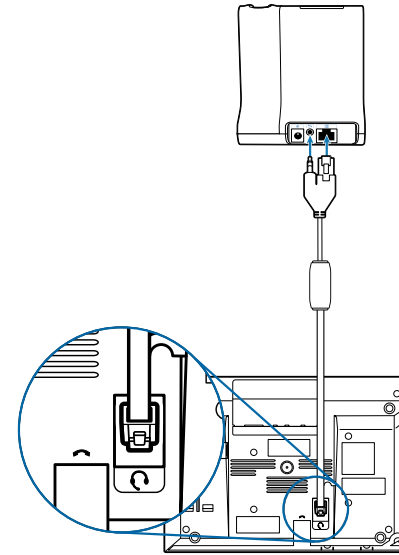

Set desk phone speaking volume to 2

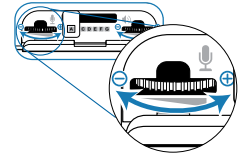

Configuration switch

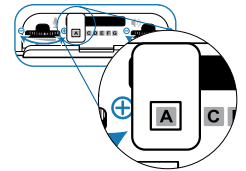

Set desk phone listening volume to 3

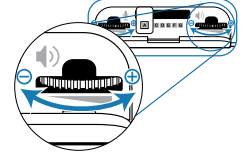

CS55/CS70N/Plantronics Voyager 510S/SupraPlus Wireless

ORDER INFORMATION

Plantronics Voyager® 510S System

Office and mobile phone usage
Use one headset for calls both in and out of the office with a noise cancelling microphone. Share seamlessly between office phone and Bluetooth® mobile phone or smart phone.
Voyager 510S



CS70N™ Wireless

Stylish and discreet
Combining the excellent sound quality and range of DECT™ with the design edge of a mobile headset.
CS70N



CS55™ Wireless

Flexible, cost effective and convenient
Cost-effective wireless headset with great range and sound quality and a choice of wearing styles.
CS55



SupraPlus® Wireless

All-day wearing comfort
For intensive phone users—the ultimate comfort and sound quality—with the option of binaural style for noisy environments.
CS351N Monaural
CS361N Binaural



REMOTE CALL ANSWERING

Requires following EHS solution to automatically answer a call by pressing a button on the headset.
APS-1 (sold separately)



SET UP INFORMATION

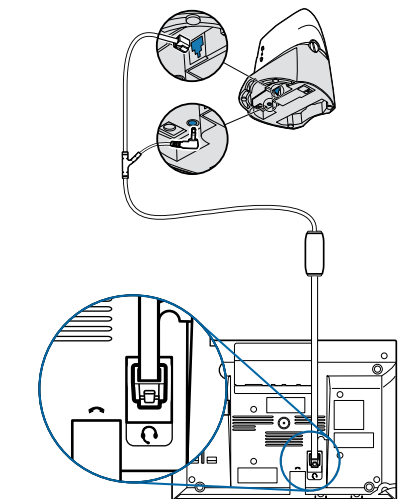

Set rotary switch to 1

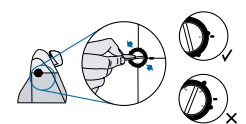

Set rear slide switch to 3

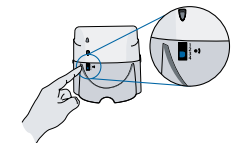

Set bottom slide switch to B

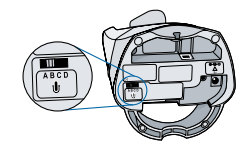

Avaya Deskphones

APV60 cable needed for 1608, 1616, 2410, 4630, 5410, 6416D&M, 6424D&M and 9600 phones

APV65 cable needed for 2420, 4610SW, 4620, 4620SW, 4621SW, 4622SW, 4625SW, 4630SW, 5420, 5610 and 5620 phones



Please check plantronics.com for more phone options.

Savi Office

ORDER INFORMATION



Savi™ Office

Designed for seamless communication
Next generation of wireless headsets to maximize collaboration through multiple devices. Enterprise grade headset system providing excellent sound quality.
WO100
(Convertible headset system)

REMOTE CALL ANSWERING

Requires following EHS solution to automatically answer a call by pressing a button on the headset.
APC-60 (sold separately)
APC-65 (sold separately)



SET UP INFORMATION

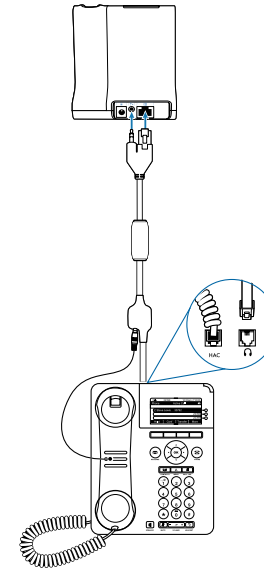

Set desk phone speaking volume to 2

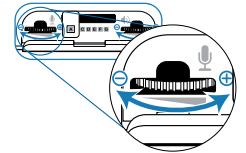

Configuration switch

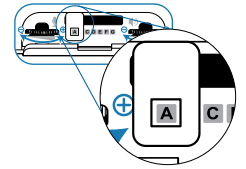

Set desk phone listening volume to 3

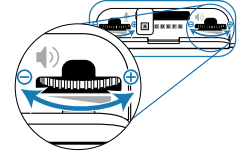

Avaya AWH75N / AWH55+ / AWH450 / AWH460N

ORDER INFORMATION



Avaya AWH75N Wireless

Stylish and discreet
Combining the excellent sound quality and range of DECT™ with the design edge of a mobile headset.
AWH75N



Avaya AWH55+ Wireless

Flexible, cost effective and convenient
Cost-effective wireless headset with great range and sound quality and a choice of wearing styles.
AWH55+



Avaya AWH450/460N Wireless

All-day wearing comfort
For intensive phone users—the ultimate comfort and sound quality—with the option of binaural style for noisy environments.
AWH450N Monaural
AWH460N Binaural



SET UP INFORMATION

For set up with AVAYA 2420, 4610SW, 4620, 4620SW, 4621SW, 4622SW, 4625SW, 4630SW, 5420, 5610 and 5620 telephones*
For a complete set up list please refer to the user guide.

*24xx and 54xx phones require 4.0 firmware or greater.
46xx and 56xx phones require 1.8 firmware or greater.

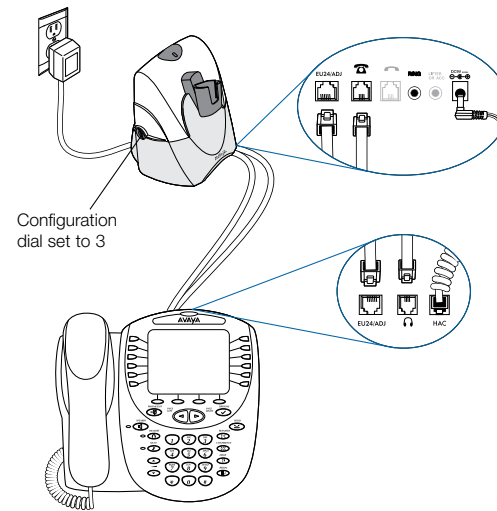

Set rotary switch to 1

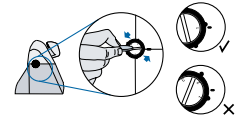

Set rear slide switch to 3

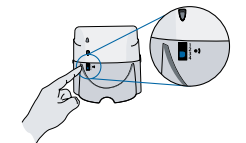

Set bottom slide switch to B

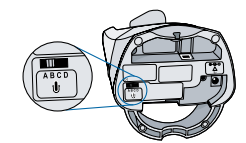



Plantronics
345 Encinal Street
Santa Cruz, CA 95060
www.plantronics.com